

MACE CS – I-Phone Application:

This guide provides how to instruction on the setup of the I-Phone Application. Plus a couple of sample screen shots to show the view of this new capability.

Requirements:

- I-Phone
- Web Portal Login for www.mymaceweb.com

How to get the Application:

- At the App store – select the Icon - Stages to download
- Settings – web portal – enter web portal login ID
- URL Setting – *m.mymaceweb.com/externalgateway/*
- Upon completion – enter password to – Login (See Sample screen shot)



Troubleshooting Tip – After downloading Stages app. and entering settings – result – no response from application – It may require rebooting your phone to launch the application.

Sample View of the I-Phone Settings page:



Navigation Tips:

The I-Phone application has the same basic feature capabilities as the web portal being used today. The search feature can be used to locate:

- Names
- Account Numbers
- Addresses
- Phone Numbers etc.

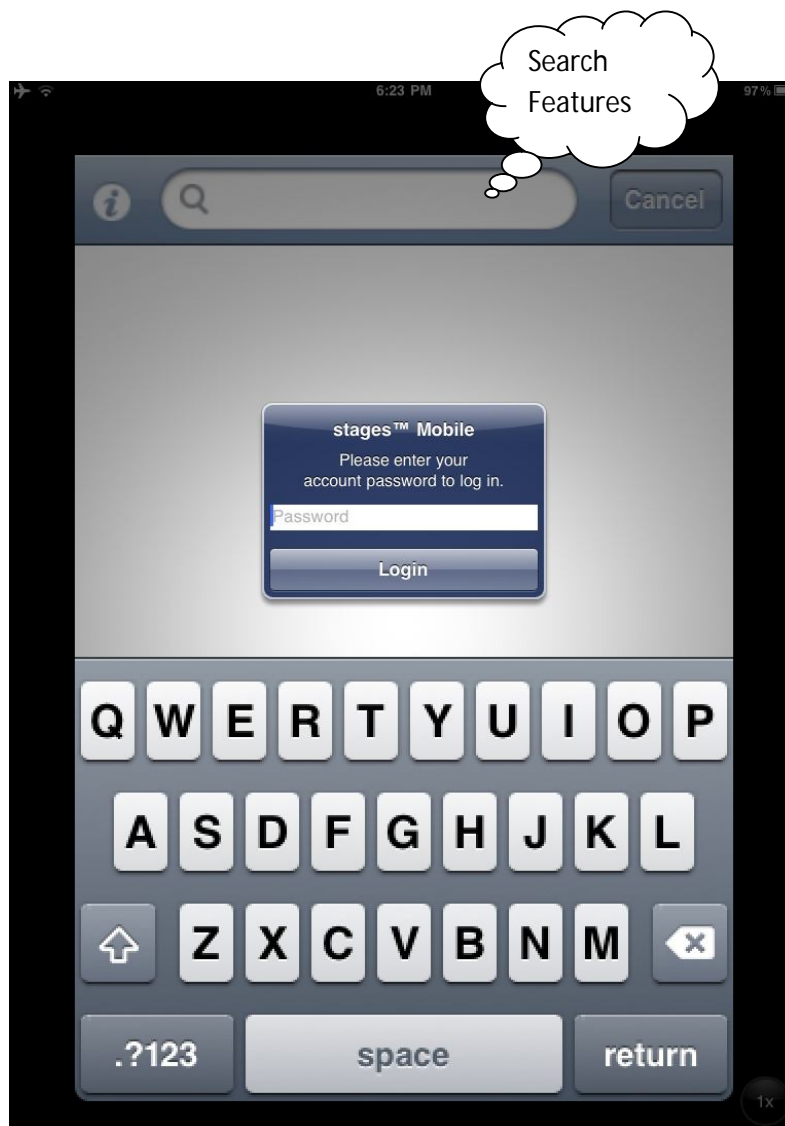

Site Account search results:

Sample view of a site

- Options to select
- On test
- Test history
- History
- Scroll down to view Premise and contact numbers

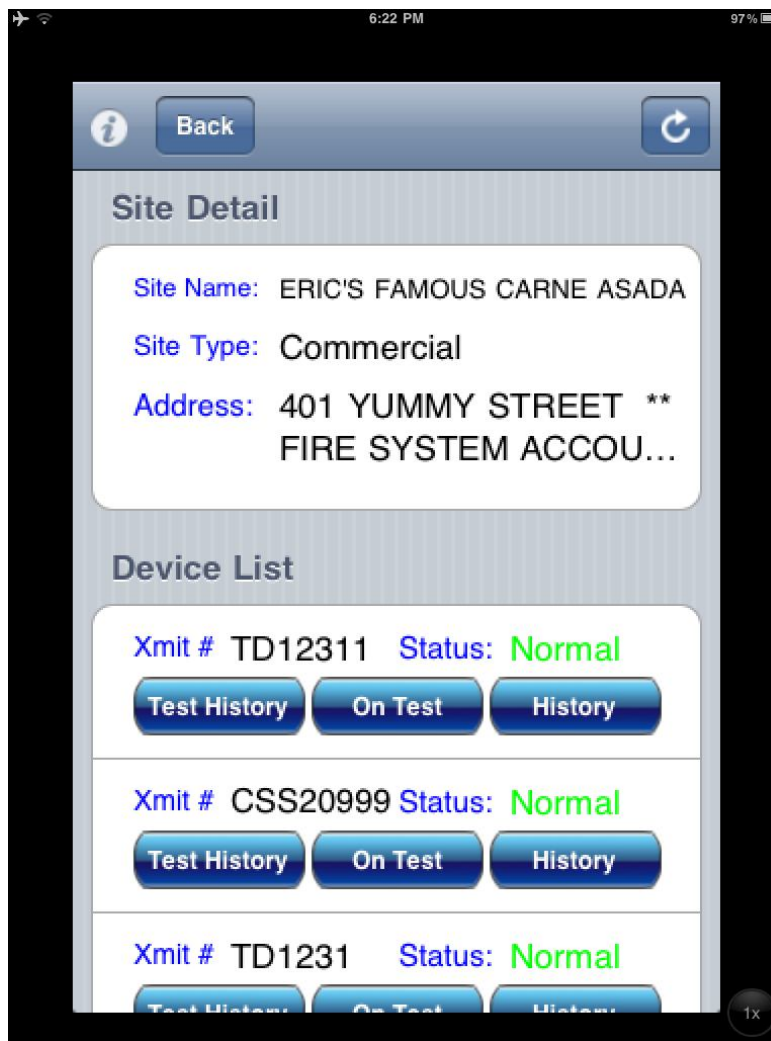

Sample History View:

The history view:

- Ability to scroll through History events
- Select either next or previous page



Exiting the Stages Application:

- Press the button to close the application



- Open Stages Icon to Re-Login